

6952



Super Lite

Serial #: 1SABV0BK1S3YB5081
Model: 212FB SUPER LITE TT

Model Year: 2025 Dealer Name: FREEDOM RV
3735 E. IRVINGTON RD
TUCSON, AZ 85714
USA



Standard Equipment

- 30' rear floor decking
- 50' awning
- Exterior galvalume quick connect port
- Flexible LP lines
- Fullsize dinette
- Fullsize bed
- In-frame battery rack
- Magnesium pass-through storage with motion light
- Rain guttering with molded drip spouts
- Self-cleaning solar panel
- Sewer bypass carrier and end caps
- Seamless fiberglass front wall
- Self-adjusting electric brakes
- Solar camera prep marker lights
- Thermal Seal - enclosed, insulated and heated underbody with fully insulated roof with a PVC roofing membrane
- Tinted-glass windows throughout
- TUVShell™ - vacuum bonded laminated construction, reinforced with heavy-duty fiberglass and welded aluminum frame
- TV Package (200 watt solar panel with 30 amp solar controller)

- 12V refrigerator
- 50' awning
- 60" x 80" residential queen bed with storage below
- 75 lb. ball bearing drawer guides
- 100' solar panel
- Cable and satellite prep
- Electrical outlets and USB ports in master bedroom
- Flush floor slides with residential vinyl flooring
- Fullsize bed
- Hidden hinge cabinet door hinges
- Kitchen sink covers
- LED interior lighting
- LED exterior lighting
- Powered 12V bathroom vent
- Range hood
- Rear door
- Roller blackout night shades
- Soft closing foot flush toilet
- Stainless steel single basin under-mount kitchen sink
- Th-Hold sole (select models)

- 15,000 BTU roof mounted A/C
- 3-burner range with 17" oven and flush mount glass cover
- Dome style digital TV antenna with Wi-Fi prep
- Enclosed exterior deck station with black tank flush
- Friction hinge entrance door with window and shade prep
- Gas/electric water heater
- Microwave
- Radial LED radial lights with aluminum fins
- Pop up windows and USB charger in bedroom
- Power awning with LED lighting
- Power tongue jack
- Power windows and cassette tops
- Rear roof access ladder
- Smart entertainment HDTV with Bluetooth®, soundbar and built in stereo

Optional Equipment

- USA STANDARDS CUSTOMER CONVENIENCE PACKAGE
- XTEND SOLAR I PACKAGE
- MANUAL STAB JACKS
- L-SOFA

Base price 34,493.00
USA STANDARDS n/c
CUSTOMER CONVENIENCE PACKAGE 4,500.00
XTEND SOLAR I PACKAGE n/c
MANUAL STAB JACKS n/c
L-SOFA n/c

UNIT TOTAL 38,993.00

DEALER INSTALLED OPTIONS

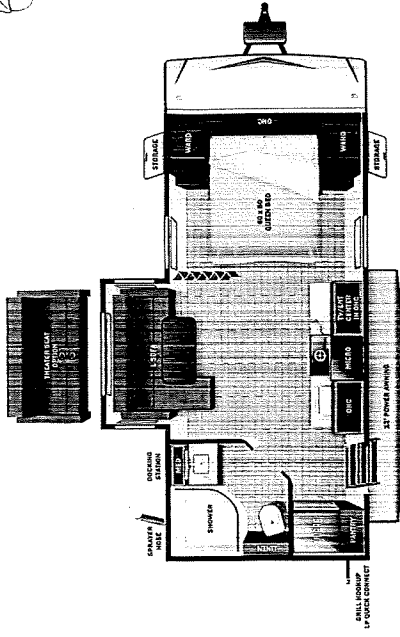

UWV 4950 lbs **Sleeps** **Length** 23' 3.13"

DIMENSIONS

Exterior height: 132.00" Fresh water tank (gals.): 45.00
Exterior width: 96.88" Gray water tank (gals.): 29.00

WEIGHTS

GVMR: 6400 (gals.): 29.00
GAWR (front): 3500 Propane (gals.): 60
GAWR (rear): 3500 Propane (gals.): 14
Approx. Gross Cargo Carrying Capacity (GCCC): 1450 Water heater (gals.): 6.00

SEATING & SLEEPING

TIRES

Tire size (front): ST205/75R14D
Tire size (mid):
Tire size (rear): ST205/75R14D



Some dimensions may be rounded and may vary from the actual dimensions
Weights may be estimated calculations and may vary from the actual weight - refer to the vehicle weight labels for actual weights
Floorplans, features and specifications are subject to change without notice.