

# SOLAIRE

BY PALOMINO

DISCOVER A WHOLE  
NEW WORLD OF  
ADVENTURE.



FOREST RIVER

FORESTRIVERINC.COM

# Welcome to SolAire.

We build with superior standards.

- Power Awning w/LED Lights
- Aluminum Wheels
- Bluetooth® AM/FM Stereo w/Speakers
- Power Tongue Jack
- 15K BTU Ducted A/C
- 200W Solar Panel
- Tub Surround w/Skylight
- Fiberglass Cap
- Ball Bearing Drawer Guides
- Microwave
- Slam Latch Baggage Doors w/Magnets
- Bathroom Power Vent
- Black Tank Flush
- Stainless Steel Kitchen Sink
- LED Interior and Exterior Lights
- White Gel Coat Exterior
- USB & USB-C Ports
- Roller Shades
- 11 cu ft Electric Refrigerator
- Built with Azdel Composite
- Ladder Bracket
- 50 Amp Service
- Broad Maple Cabinets
- Full Front Cap w/Line-X Rock Guard  
*(2300/3060/3200/3300 Only)*



Solaire ultra light travel trailers are easy to tow, yet built to last with a sturdy aluminum framed superstructure for long lasting durability.

## AVAILABLE OPTIONS

### SOLAIRE ULTRA LITE

- Bedroom Air Conditioner  
*(N/A 2080, 2085)*
- 3rd Air Conditioner  
*(N/A 2080, 2085, 2430)*
- 32" TV *(2080, 2085 Only)*
- 43" TV *(N/A 2080, 2085)*
- 2nd Hide-A-Bed IPO Theater Sofa *(3060 Only)*
- Fireplace *(N/A 2080, 2085)*
- Free Standing Tables & Chairs *(2580, 3150, 3200 Only)*
- 12V Heated Holding Tanks
- Bedroom Power Vent
- Outside Griddle w/Prep Table
- Power Stabilizer Jacks
- Tri-Fold Sofa *(2085, 2300, 2420, 2580, 3060, 3150, 3200 Only)*
- Theater Seating *(2080, 2085, 2580, 3150, 3200 Only)*
- Washer/Dryer *(2580, 3060, 3200 Only)*
- WiFi Booster

### Lakefront package

- White Two-Tone Cabinets
- Upgraded Bed Spread
- Decorative Pillows
- Slide Out Hybrid Carpet



# Palomino Premium Build Quality

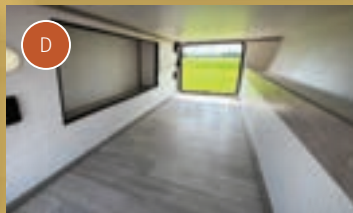
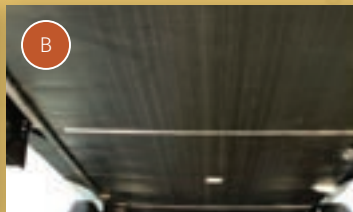

## KEY FEATURES

- A. Glued and screwed wood cabinetry
- B. Heated underbelly to protect trailer components as well as increase aerodynamics
- C. 5/8" Drymax water resistant decking glued and screwed to aluminum framing with Azdel construction and high gloss gel coat fiberglass
- D. Heated pass thru storage

## WALL STRENGTH

Structurally engineered materials makes our vacuum-bonded walls some of the strongest in the industry.



## VACUUM-BONDED LAMINATED CONSTRUCTION

Palomino provides six sided aluminum framing. As well as vacuum bonded walls and roof to ensure a well-insulated, light weight and structurally sound trailer.



**We Build with Superior Standards.**



The Ultra Lites are the result of superior design and modernization. In efforts to delight our customers, an aluminum superstructure frame was developed for light weight towing and barreled ceilings were integrated for a more spacious interior.

# NON-BUNK MODELS

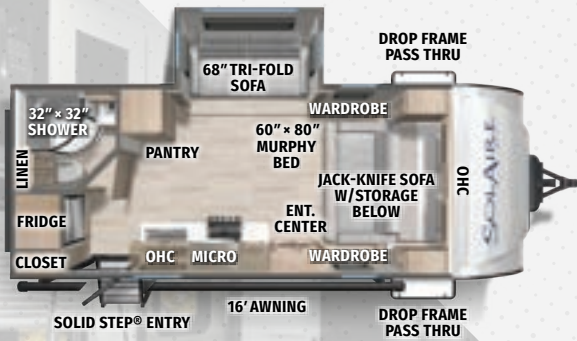

**2080 RBS**

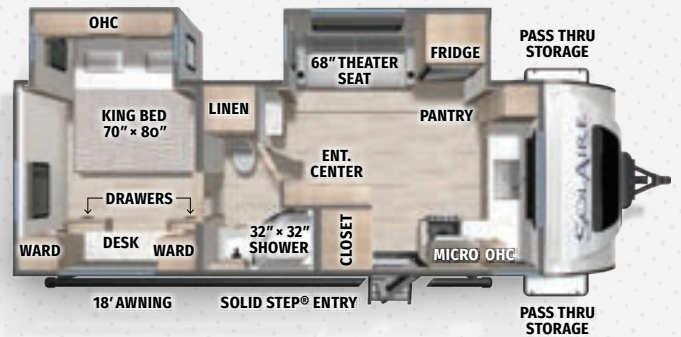

**2300 FKBS**

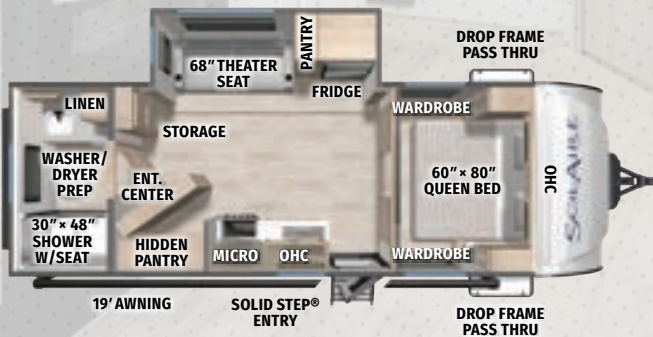

**2420 RBS**



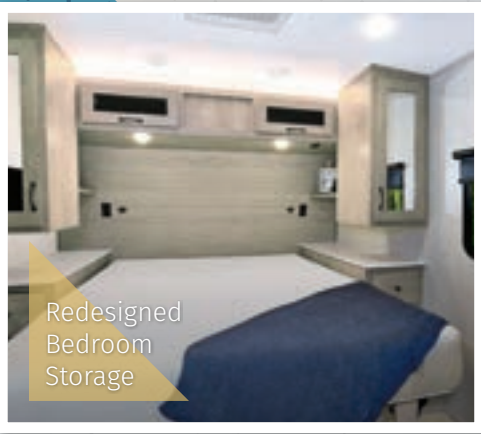

Redesigned  
Bedroom  
Storage

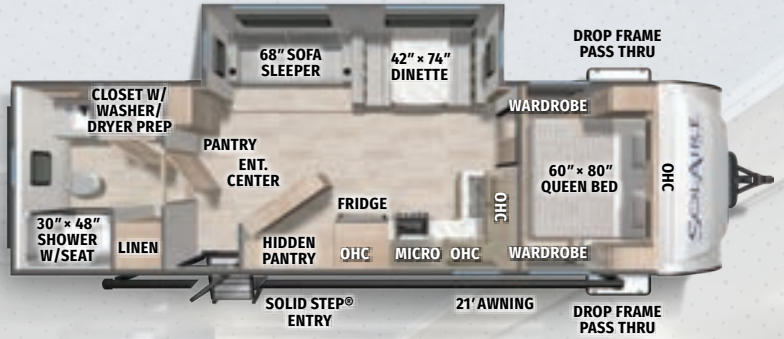

## 2580 RBSS



Hidden Kitchen  
Pantry Storage  
(2420, 2430, 2580,  
3150 Only)

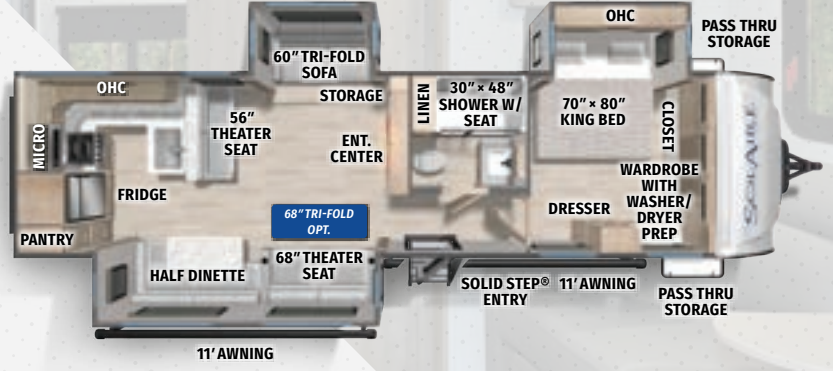

## 3060 RKTS



Porcelain  
Toilet  
Standard

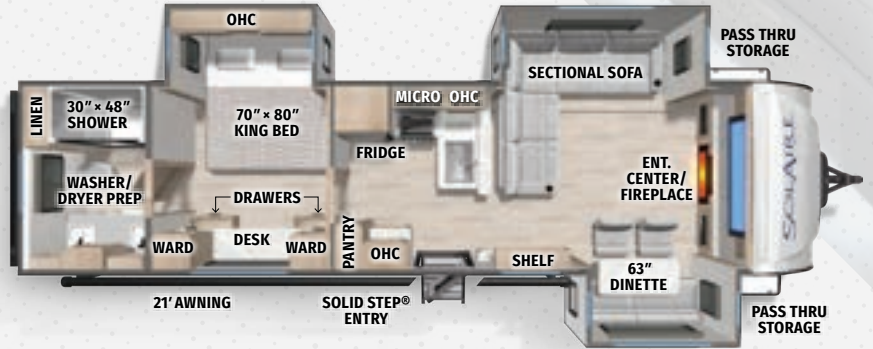

## 3300 FLBS

\*Standard w/65" TV & Fireplace

SPECS	LENGTH	WIDTH	INT. HEIGHT	EXT. HEIGHT	AWNING	HITCH	AXLE	UVW	CCC	FRESH WATER	GRAY WATER	BLACK WATER
2080 RBS	24'	8'	6' 8"	10' 7"	16'	660	4150	4848	1502	42	38	30
2300 FKBS	26' 9"	8'	6' 8"	11' 1"	18'	685	4925	5648	1550	42	60	30
2420 RBS	27' 11"	8'	6' 8"	11' 1"	19'	635	4655	5328	1575	42	68	38
2580 RBSS	32' 8"	8'	6' 8"	11' 1"	21'	725	5250	6013	1615	42	68	38
3060 RKTS	37'	8'	6' 8"	11' 1"	11', 11'	1050	6715	7803	1900	42	106	38
3300 FLBS	36' 10"	8'	6' 8"	11' 1"	21'	1015	6640	7693	1950	42	76	38

# NEW CONVERTIBLE BUNK SYSTEM



Double Bunks



Workstation



Bottom Bunk



Storage

## BUNK MODELS

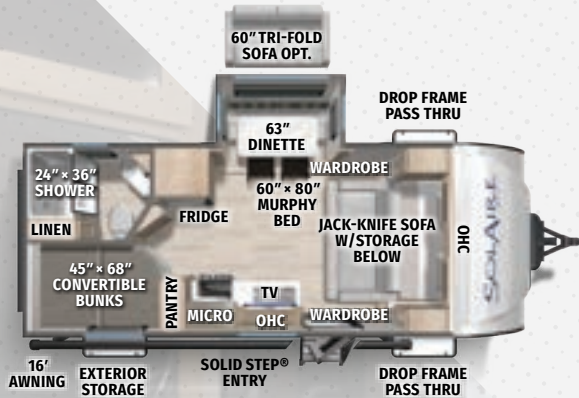

2085 BHS

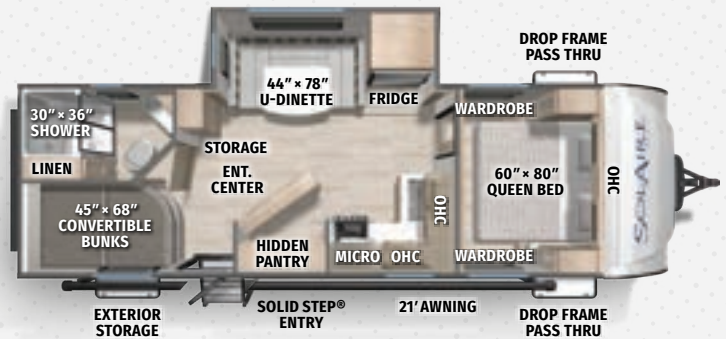

2430 BHS



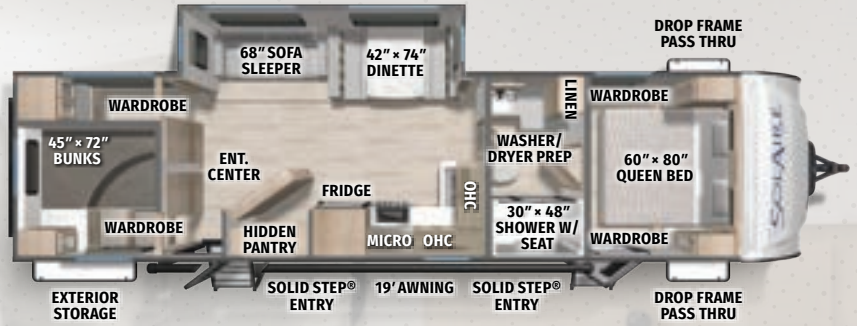

## 3150 TBSS



Separated Bunk Rooms w/ Individual Wardrobes (3150 Only)

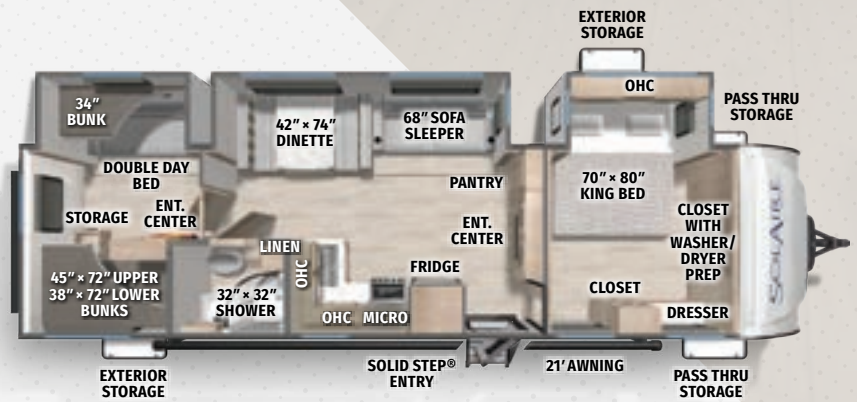

## 3200 TSBH



Shown with Free Standing Table and Chairs Option

SPECS	LENGTH	WIDTH	INT. HEIGHT	EXT. HEIGHT	AWNING	HITCH	AXLE	UVW	CCC	FRESH WATER	GRAY WATER	BLACK WATER
2085 BHS	24'	8'	6' 8"	10' 7"	16'	520	4290	4848	1497	42	60	30
2430 BHS	30' 7"	8'	6' 8"	11' 1"	21'	645	4990	5673	1596	42	60	30
3150 TBSS	36' 10"	8'	6' 8"	11' 1"	19'	880	5835	6753	1990	42	76	38
3200 TSBH	36' 5"	8'	6' 8"	11' 1"	21'	995	6425	7458	1937	42	68	30

# Our Warranty

Palomino will stand behind our products 100%. For complete details on our warranty program, please see your Palomino dealer.

- 2 Year Fiberglass Warranty
- 10 Year Axle Warranty
- Lifetime Alpha Super Flex Roof Warranty
- 2-3 Year Warranty on Appliances (*See Manual for Details*)
- 1 Year Bumper to Bumper Warranty

# PALOMINO

1047 EAST M-86 | COLON, MI 49040

P: 269.432.3271 | F: 269.432.2516

WWW.PALOMINORV.COM



FOLLOW US



@PalominoRVs



The National RV Dealers Association (RVDA) has recognized Palomino in their 30th annual Dealer Satisfaction Index (DSI) survey with a Quality Circle Award. Palomino scored 4.25 or above on a 5-point scale in overall dealer satisfaction.

Manufacturers are rated on the following core issues:

- Reliability/Quality
- Warranty
- Parts
- Sales

Visit [www.rvda.org](http://www.rvda.org) information about the RVDA.

## EACH NEW FOREST RIVER PURCHASE PROVIDES:

- ✓ Pre-delivery Inspection.
- ✓ Digital Owner's Manual.
- ✓ Free Membership to Forest River Owners Group (FROG).  
Learn more at [www.forestriverfrog.com](http://www.forestriverfrog.com).
- ✓ A Contribution to Care Camps Foundation [www.carecamps.org](http://www.carecamps.org).
- ✓ 1 Year Free Roadside Assistance from Date of Purchase.



### LEARN MORE:

Scan this QR code with your mobile device to learn more about Forest River.



## SPECIFICATION DEFINITIONS:

Scan this barcode using a QR reader on your smartphone to learn RV terminology and more!



YOUR **SOLAIRE** DEALER