

Jayco | 2025 Melbourne Class C Motorhome



# MELBOURNE

COMPACT COMFORT & LUXURY

**2+3**  
YEAR | YEAR  
WARRANTY



ASHBROOK



Wood



Floor



Countertop



Main Fabric



Furniture

# MELBOURNE



24L OPTIONS: A, B

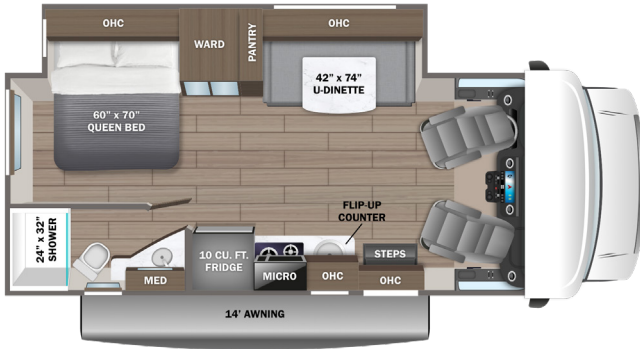

24R OPTIONS: A, B

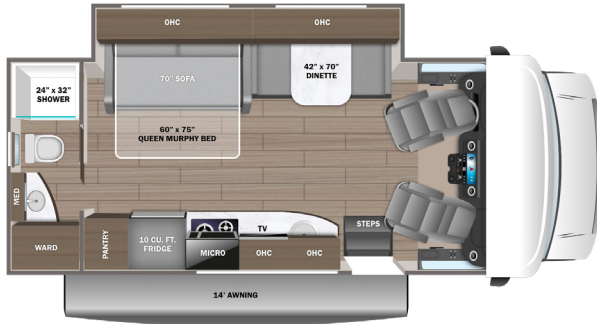

## OPTIONS

A



Theater Sofa

B



Entertainment Center  
with Overhead Storage

## EXTERIOR SELECTIONS



Standard Graphics Package



Optional Partial Paint

# STANDARDS & OPTIONS

## CUSTOMER VALUE PACKAGE

One-piece, seamless, fiberglass front cap  
 Frameless windows  
 Heated holding tanks (12V pads)  
 Heated, remote-controlled, side-view mirrors  
 Electric patio awning with LED lights  
 Backup and side-view cameras  
 Keyless cab entry  
 7 in. integrated Mercedes-Benz® MBUX infotainment center with Apple® CarPlay™ and Android Auto™  
 Swivel driver and passenger seats

## DRIVING

Mercedes-Benz® 3500 chassis with 170 in. wheelbase  
 GVWR- 11,030 lb.  
 GCWR- 15,250 lb.  
 2L V4 Twin Turbo 211HP diesel engine with electronic fuel injection with 332 ft.-lb. torque  
 9-speed automatic transmission  
 220-amp alternator  
 E-rated highway tires- 215/85R16  
 Front and rear disc, 4-wheel anti-lock brakes  
 5,000 lb. rear hitch receiver with dual connector 7-pin plug  
 12V chassis battery  
 26.4 gal. fuel tank  
 5.8 gal. DEF tank  
 Tilt steering wheel  
 Power windows and door locks  
 Cruise control  
 Crosswind assist  
 Hill start assist  
 Attention assist  
 Brake Assist Plus  
 Breakdown management  
 Emergency call system  
 Headlight assistant  
 Auxiliary start switch  
 Driver and passenger airbags  
 Privacy curtain for cab area

## EXTERIOR

StrongholdVBL™ roof, floor and sidewalls  
 Bead-foam insulation (R-24 max roof, R-9 max floor, R-5 max walls)  
 Tufflex™ PVC laminated roof  
 Fiberglass running boards

Fiberglass exterior walls with vinyl graphics  
 Electric stabilizer jacks  
 Slideout awning(s)  
 Entrance door with industry's largest travel-view window  
 Electric-powered entrance step with integrated house battery compartment  
 Third brake light  
 4 in. bumper tube with sewer hose storage  
 Prep for satellite dish  
 Cable TV hookup with RG-6 coax  
 Digital antenna with signal booster  
 3,600W LP generator with (4,000W on select models)  
 Solar prep  
 12V house battery  
 Transfer switch with reverse polarity protection  
 30-amp electrical service  
 12.2 gal. propane tank (41 lb.)  
 LP quick-connect hookup  
 Exterior utility center  
 Winterization drain system  
 Black tank flush  
 Outside shower  
 12V demand water pump  
 Water filtration system

## INTERIOR

Overhead bunk with 750 lb. capacity  
 83 in. interior ceiling height with padded vinyl ceiling  
 High-intensity, LED ceiling lights  
 LED-lit slideout fascia  
 Hardwood cabinet doors and drawer fronts  
 Ball-bearing drawer guides  
 Pleated blackout shades  
 13,500 BTU A/C  
 30,000 BTU auto-ignition ducted furnace  
 6 gal. gas/electric water heater and water heater bypass  
 Powered roof vent in living area with wall switch  
 Jayco-exclusive, easy-operation legless dinette table (24R)  
 U-shaped dinette with stow away pedestal legs (24L)  
 12V USB charging station in dinette area  
 2-point lap safety belts in all designated seating locations  
 Car seat tethers (select floorplans)

LED HD Smart TV  
 JBL® audio system  
 10 cu. ft. 12V refrigerator  
 2-burner, drop-in cooktop with flush cover  
 Convection microwave  
 Stainless steel sink with wooden cover/cutting board  
 LED-lit pressed countertops  
 Flip-up countertop extension (select models)  
 Decorative kitchen backsplash  
 Shower with decorative surround and skylight  
 Stainless steel bathroom sink  
 Toilet with foot flush  
 Powered roof vent in bathroom with wall switch  
 Queen-size bed with bedspread (24L)  
 Queen-size power Murphy bed (24R)  
 USB port(s) in bedroom  
 Bedroom TV prep  
 Large wardrobes  
 Smoke alarm  
 Carbon monoxide detector  
 Fire extinguisher

## OPTIONS

Premium Mercedes chassis - includes active brake assist, chrome grill package, adaptive cruise control, heated captain's seats, smart phone tray with wireless charging, upgraded lighting package, rain-sensing wiper system, leather steering wheel, lane-keeping assist and traffic sign assist.  
 Front entertainment center with 32 in. LED HD Smart TV  
 Folding windshield sun shade  
 4-point hydraulic leveling jacks  
 Theater seating ILO dinette  
 200W solar panel with dual controller and second house battery

FLOORPLAN	GVWR (lbs.)	GCWR (lbs.)	WHEEL BASE	OVERALL LENGTH	EXTERIOR HEIGHT WITH SATELLITE AND A/C	EXTERIOR WIDTH	INTERIOR HEIGHT	FRESH WATER CAPACITY (gal.)	GRAY WASTE WATER CAPACITY (gal.)	BLACK WASTE WATER CAPACITY (gal.)
24L	11,030	15,250	170.3"	25' 2"	11' 5"	96"	83"	43	31	31
24R	11,030	15,250	170.3"	25' 2"	11' 5"	96"	83"	35	31	31

Meet your Jayco Dealer



Scan QR code for specification definitions

Some specs at the time of print may include estimates. For the most updated information, please visit [Jayco.com](http://Jayco.com)

Jayco Inc. | P.O. Box 460 | Middlebury, IN 46540

See dealer for further information and prices. All information in this brochure and on [www.jayco.com](http://www.jayco.com) is the latest available at the time of publication approval. Jayco reserves the right to make changes and to discontinue models without notice or obligation. Photography may show optional equipment or props used for decoration purposes only. RVs built for sale in Canada may differ to conform to Canadian codes. JAYCO and the JAYCO BIRD IN FLIGHT are registered trademarks of Jayco, Inc. Printed in USA 10/24 ©2024 Jayco, Inc. 2032956



Jayco - Part of Jayco Family of Companies