



Jay Feather Air



Serial #: 1UJBB0AJ0S1HB0070
 Model: 16RB JAY FEATHER AIR TT

Model Year: 2025 Dealer Name: CAMPERLAND OF OKLAHOMA-SAPULPA
 9889 STATE HWY 66
 Sapulpa, OK 74066
 USA

Manufacturer's Suggested Retail Price \$44,093.00

TOTAL AMOUNT DOES NOT INCLUDE STATE AND LOCAL TAXES OR LICENSE FEES. THE PRICE SHOWN ABOVE MAY OR MAY NOT BE REPRESENTATIVE OF THE ACTUAL SELLING PRICE OF SIMILAR RECREATIONAL VEHICLES IN YOUR AREA.

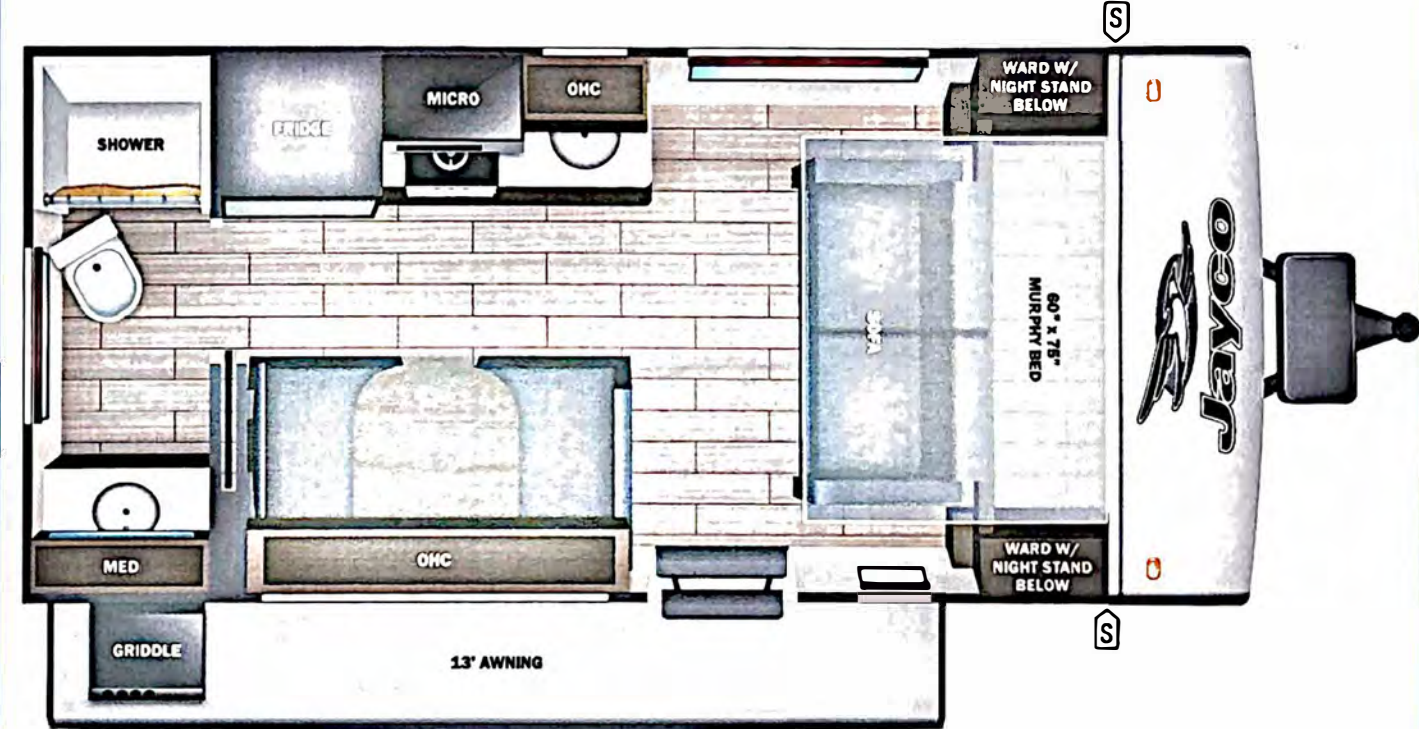

Standard Equipment

Optional Equipment

THE FOLLOWING ITEMS ARE STANDARD ON THIS MODEL AT NO EXTRA CHARGE

OPTIONAL EQUIPMENT INSTALLED ON THIS VEHICLE BY MANUFACTURER

- STANDARD EXTERIOR EQUIPMENT**
- 1.5 in. fresh water drain valve
 - 18 in. rear roof ladder - factory installed
 - 2 in. Stronghold VBL™ floor with 2 lb. density foam
 - Stronghold VBL™ walls with double-sided Azdel composite (sidewalls, rear walls and slide out boxes)
 - Aerodynamic, rounded front profile with aluminum framing
 - American-made Norco Z-frame with integrated A-frame
 - Automotive-style aluminum rims
 - Battery quick-disconnect
 - Dark-tinted safety-glass windows
 - Exterior TV bracket with 120V and cable hook-ups
 - Front diamond plating backed with Azdel
 - Galvanized steel and impact resistant wheel wells
 - Keyed-Alike™ locking system
 - Magnum Truss™ Roof System
 - Mounted camera bracket for pre-wired side and rear back-up prep
 - PVC roofing membrane (limited lifetime warranty)
 - Swing-out entry door assist handle

- STANDARD INTERIOR EQUIPMENT**
- 4 in. high-density dinette cushions with vinyl backing
 - 4 in. soft-touch bunk mats (select models)
 - 75 lb. full extension drawer guides
 - Bathroom skylight
 - Decorative backsplash
 - Decorative roller shades with reflective barrier
 - Handcrafted, hardwood door/drawer fronts
 - Hidden-hinged cabinet doors
 - High output auto-ignition LP gas furnace
 - LED lighting throughout
 - Plywood dinette, bed, bunk and shower/tub bases
 - Powered roof vents in bathroom and main bedroom (most models)
 - Residential vinyl flooring throughout
 - Residential-style seamless countertops throughout
 - Screwed and glued cabinet stiles
 - USB charging ports (multiple locations throughout)

Base price	34,043.00
USA STANDARDS	n/c
CUSTOMER VALUE PACKAGE	6,000.00
JAY AIR PACKAGE	3,750.00
OVERLANDER I SOLAR PACKAGE	n/c
15,000 BTU AC	300.00
20# LP GAS BOTTLES	n/c
GOODYEAR ENDURANCE TIRES	n/c

- CUSTOMER VALUE PACKAGE (MANDATORY)**
- American-made nitro-filled Goodyear® radial tires with self-adjusting electric brakes
 - 13,500 BTU roof-mounted A/C
 - 2 Burner cooktop
 - 20 lb. LP gas bottles with auto-regulator and ABS cover
 - 55 gal. fresh water tank
 - Automotive-style aluminum rims
 - Black tank flush
 - Convection microwave
 - Detachable power cord
 - Inverter pre-wire
 - Max-length power awning with LED light
 - On-demand water heater
 - Power tongue jack
 - Rock Solid Stabilizer System
 - Side and rear back-up camera prep
 - Under-mount spare tire

- JAY AIR PACKAGE (MANDATORY)**
- 11 cu. ft. 12V fridge
 - 2 in. rear receiver
 - App monitored TPMS
 - Climate Shield (zero to 100 degree tested weather insulation package)
 - Invision appliance package
 - LCI Solid Step fold-down aluminum tread steps on main entry door
 - LED smart TV
 - MAXXAIR® power roof vent (main living area)
 - Modern graphics package with dual-colored sidewall
 - Overlander 1 Solar Package: (1) 200W solar panel and 30-amp digital controller
 - Stainless steel kitchen & bathroom sink

UNIT TOTAL **44,093.00**

DEALER INSTALLED OPTIONS

UVW
4005 lbs

Sleeps
2

Length
20' 2"

DIMENSIONS

Exterior height:.....130.25"
 Exterior width:.....95.50"
WEIGHTS
 GVWR:.....4995
 GAWR (front):.....5145
 GAWR (rear):.....0
 Approx. Gross Cargo Carrying Capacity(GCCC):.....990

CAPACITIES

Fresh water tank (gals.):...55.00
 Gray water tank (gals.):...38.00
 Black water/toilet tank (gals.):...30.00
 Propane (lbs.):...40
 Propane (gals.):...9
 Water heater (gals.):...0.25

TIRES

Tire size (front):.....ST225/75R15E
 Tire size (mid):.....
 Tire size (rear):.....
 Tire size (spare):.....ST225/75R15E

SEATING & SLEEPING



Some dimensions may be rounded and may vary from the actual dimensions
 Weights may be estimated calculations and may vary from the actual weight - refer to the vehicle weight labels for actual weights
 Floorplans, features and specifications are subject to change without notice.

25 SP783N