



Jay Feather



Serial #: 1UJBB0BP9S14F0218
Model: 26FK JAY FEATHER TT

Model Year: 2025 Dealer Name: CAMPERLAND OF OKLAHOMA LLC
8347 EAST 11TH STREET
TULSA, OK 74112
USA

Manufacturer's Suggested Retail Price \$62,064.00

TOTAL AMOUNT DOES NOT INCLUDE STATE AND LOCAL TAXES OR LICENSE FEES. THE PRICE SHOWN ABOVE MAY OR MAY NOT BE REPRESENTATIVE OF THE ACTUAL SELLING PRICE OF SIMILAR RECREATIONAL VEHICLES IN YOUR AREA.

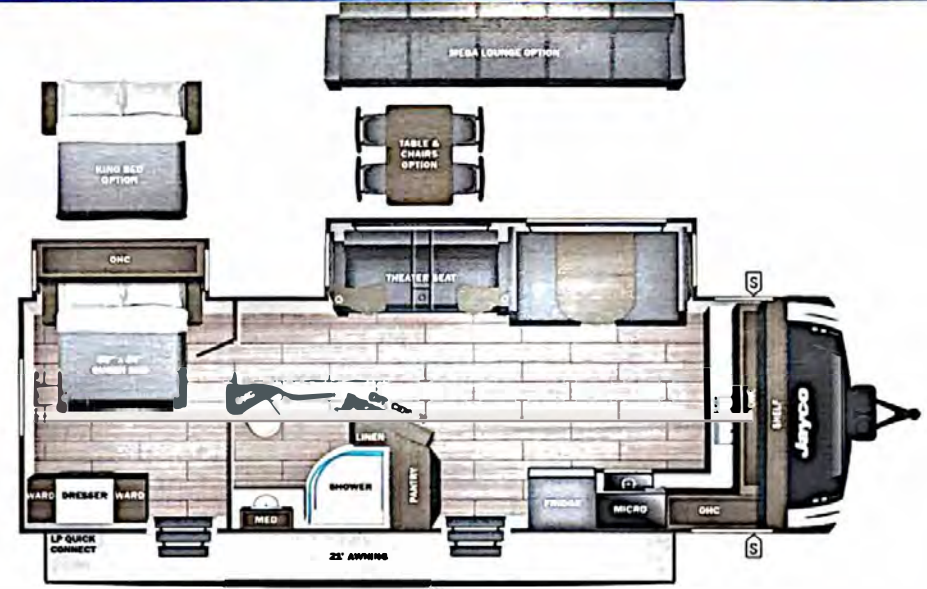

UVW 7362 lbs **Sleeps** **Length** 31' 9"

DIMENSIONS
Exterior height:.....131.50"
Exterior width:.....96.00"

WEIGHTS
GVWR:.....8500
GAWR (front):.....4400
GAWR (rear):.....4400
Approx. Gross Cargo Carrying Capacity (GCCC):.....1138

TIRES
Tire size (front):.....ST225/75R15E
Tire size (mid):.....
Tire size (rear):.....ST225/75R15E
Tire size (spare):.....ST225/75R15E

CAPACITIES
Fresh water tank (gals.):...54.00
Gray water tank (gals.):...60.00
Black water/toilet tank (gals.):...30.00
Propane (lbs.):.....40
Propane (gals.):.....9
Water heater (gals.):.....0.25

SEATING & SLEEPING

Standard Equipment

THE FOLLOWING ITEMS ARE STANDARD ON THIS MODEL

- STANDARD EXTERIOR EQUIPMENT**
- 1.5 in. fresh water drain valve
 - 18 in. rear roof ladder - factory installed
 - 2 in. Stronghold VBL™ floor with 2 lb. density foam
 - Stronghold VBL™ walls with double-sided Azdel composite (sidewalls, rear walls and slide out boxes)
 - Aerodynamic, rounded front profile with aluminum framing
 - American-made Norco Z-frame with integrated A-frame
 - Automotive-style aluminum rims
 - Battery quick-disconnect
 - Dark-tinted safety-glass windows
 - Exterior TV bracket with 120V and cable hook-ups
 - Front diamond plating with Azdel backer
 - Front molded decorative cap (select models)
 - Galvanized steel and impact resistant wheel wells
 - Keyed-Alike™ locking system
 - Magnum Truss™ Roof System
 - Marine grade exterior speakers
 - Outdoor camp kitchen with galvanized steel bases (select models)
 - PVC roofing membrane (limited lifetime warranty)
 - Swing-out entry door assist handle
- JAY SPORT PACKAGE (MANDATORY)**
- 11 cu. ft. 12V fridge
 - App monitored TPMS
 - Climate Shield (zero to 100 degree tested weather insulation package)
 - Front slam-latch baggage doors
 - Invision appliance package
 - LCI Solid Step fold-down aluminum tread steps on main entry door
 - LED smart TV
 - MAXXAIR® power roof vent (main living area)
 - Modern graphics package with dual-colored sidewall
 - Overlander 1 Solar Package: (1) 200W solar panel and 30-amp digital controller
 - Porcelain foot-flush toilet
 - Stainless steel kitchen & bathroom sink

Optional Equipment

OPTIONAL EQUIPMENT INSTALLED ON THIS VEHICLE BY MANUFACTURER

Base price	49,785.00
USA STANDARDS	n/c
CUSTOMER VALUE PACKAGE	6,000.00
JAY SPORT PACKAGE	3,750.00
OVERLANDER I SOLAR PACKAGE	n/c
NO JAYCOMMAND CONTROL SYSTEM	n/c
15,000 BTU AC	300.00
2NDAC	893.00
FIREPLACE	443.00
20# LP GAS BOTTLES	n/c
FRONT MOLDED CAP	893.00
RANIER TIRES	n/c
THEATER SEATING	n/c
DINETTE	n/c
QUEEN BED	n/c

UNIT TOTAL **62,064.00**
DEALER INSTALLED OPTIONS

25-22645N

Some dimensions may be rounded and may vary from the actual dimensions
Weights may be estimated calculations and may vary from the actual weight
- refer to the vehicle weight labels for actual weights***
Floorplans, features and specifications are subject to change without notice.

