

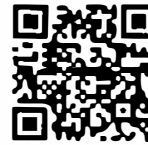

North Point



Serial #: 1UJCD0BV9S1LN0069
 Model: 381CKRE NORTH POINT FW

Model Year: 2025 Dealer Name: CAMPERLAND OF OKLAHOMA LLC
 8347 EAST 11TH STREET
 TULSA, OK 74112
 USA

Standard Equipment

Optional Equipment

THE FOLLOWING ITEMS ARE STANDARD ON THIS MODEL

OPTIONAL EQUIPMENT INSTALLED ON THIS VEHICLE BY MANUFACTURER

- STANDARD EXTERIOR EQUIPMENT**
- (3) 40 lb. propane bottles with auto regulator (120 lb. max LP system)
 - 102 in. wide body construction
 - 12 in. structural steel I-beam with 10 in. steel drop frame
 - 3,000 lb. tow hitch with 4-way pin (N/A 390CKDS)
 - Battery disconnect
 - Built in sewer hose ciner
 - Climate Shield™ zero-degree tested weather protection
 - 40,000 BTU output furnace
 - Double layer fiberglass batt insulation (roof and floor)
 - Fully-enclosed and heated underbelly (ducted)
 - PEX plumbing, 2 in. block foam and reflective foil
 - Custom automotive-grade vinyl exterior graphics package
 - Digital TV antenna with 5G Wi-Fi extender
 - Exterior marine-grade speakers with Bluetooth® controller
 - Frameless, dark tinted, safety-glass windows
 - Fully enclosed, universal docking center
 - Black tank flush
 - Independent satellite wiring
 - Quick-connect outside shower
 - Selectable water connections
 - Whole coach cable-hookups
 - Winterization and sanitation hookups
 - Inverter pre-wire to select outlets
 - JayPort system for outside griddle (all floorplans without a standard outside kitchen)
 - JaySMART™ (Safety Markers And Reverse Travel) LED lighting (patented)
 - LED exterior lighting package
 - Magnum Truss™ XL6™ Roof System (strongest tested roof in the industry) with Alpha roof membrane system with limited lifetime warranty
 - Painted fiberglass front cap with clear coat and built-in specialty LED lighting
 - Pass-through storage with Slam-latch™ baggage doors
 - Skirt metal enclosed drop frame
 - Stronghold VBL™ aluminum framed and vacuum bond laminated gel coated fiberglass exterior walls (including rear wall and slide room end walls)
 - Under-mounted spare tire
 - Water heater bypass
- CUSTOMER VALUE PACKAGE (MANDATORY)**
- 15,000 BTU Whisper Quiet™ A/C (main)
 - 15,000 BTU Whisper Quiet™ A/C (bedroom)
 - 16 gal. gas/electric DSI water heater
 - 50 in. 4K Smart LED HDTV with fully digital HDMI® output and two extra HDMI cables
 - Backup, main entrance door and side observation security camera prep (includes a power switch in the bedroom to use the optional 7 in. monitor for security)
 - Custom machined aluminum nms
 - Electric patio awning with integrated RGB LED lights (Multi-color with remote control)
 - Hidden hinges, magnet latches and soft close cabinet doors and drawers
 - JBL® home entertainment system with sound bar and wireless subwoofer
 - Keyed-Alarm™ lock system (single key for all doors/locks)
 - MORryde Safe-T-Rail grab handle
 - Residential king (72 in. x 80 in.) mattress with under-bed storage
 - Rooftop and ground solar prep
 - Tire pressure monitoring system
 - Wireless remote control system (includes Bluetooth® wireless controls) with dimmer switches

- STANDARD INTERIOR EQUIPMENT**
- 5/8 in. tongue-and-groove joined plywood floor decking
 - Bathroom skylight
 - Built in spice rack inside kitchen cabinet door (select models)
 - Built-in laundry hamper in wardrobe (select models)
 - Carbon monoxide and LP detector
 - Ceiling fan (select models)
 - CPAP prepped bedroom
 - Dual USB charging ports throughout
 - Extra 120V power outlets in kitchen and slide rooms
 - Flip-up countertop extension/bar top (n/a 382FLRB)
 - Flip-up hidden storage in bedroom chest of drawers (select models)
 - Flip-up tabletop storage next to tri-fold sofa (select models)
 - Handcrafted hardwood glazed doors and drawers
 - Integrated under-mount sink and lever faucet in main bath
 - LED accent lighting above slideouts
 - LED backlit custom framed mirror and medicine cabinet (n/a 382FLRB)
 - LED interior lighting throughout
 - No in floor heat registers throughout coach
 - Pantry with adjustable shelves and pull out drawers
 - Pull out "Roll Top" dinette
 - Pull-out utility drawer under kitchen sink
 - Removable TV tray tables at theater seats
 - Residential "Do it all" sink with pull-out kitchen faucet, glass rinse, and vegetable rinse
 - Residential finished dove tail jointed drawers throughout
 - Residential NuVo H2O whole coach water treatment system with water softening and triple cartridge filters
 - Residential quilted bedspread and pillow shams
 - "Shoe garage" in hallway step (select models)
 - Soft close, heavy-duty, 75 lb. full-extension, drawer guides
 - Solid hardwood slide fascia
 - Stain protected fabric on all furniture
 - Toe lock nightlights in bedroom and bathroom
 - Tri-fold hide-a-bed sofa with residential sleep surface
 - True interior design (Modern Farmhouse)
 - Up/down switch to raise/lower the TV by theater seats
 - Vinyl flooring throughout (includes slideout floors)
- 5 STAR HANDLING PACKAGE (MANDATORY)**
- 17.5 in. 16 ply "H" rated Uniroyal tires
 - Dexter® Axles with ABS and Tow Assist - includes Nev-R-Adjust® brakes and E-Z Lube® hubs
 - MORryde® CRE-3000™ rubberized suspension
 - MORryde® rubber pin box
 - Wet bolt fasteners, bronze bushings and 4k lb. leaf springs
- LUXURY PACKAGE (MANDATORY)**
- 2nd electric patio awning with integrated RGB LED lights (multi-color with remote control)
 - 32 in. 4K Smart bedroom TV
 - 6-point hydraulic auto-leveling system
 - Cellular prep for 5G Wi-Fi repeater
 - Central vacuum system with dust port
 - Frameless dark tinted safety-glass windows
 - Free-standing roll top (no pedestal) table with (2) free-standing and (2) folding chairs
 - GE 21 cu. ft. residential refrigerator with 1800W inverter
 - GE Profile Series residential 24 in. range (37 cu. ft.)
 - High gloss gel coated slidewalls
 - JAYCOMMAND® Smart RV System
 - LED fireplace with electric space heater
 - MORryde® StepAbove™ entrance steps with strut assist
 - Oversized multi-battery compartment (room for 4-6 batteries)
 - Privacy roller shades
 - Residential solid-surface kitchen counter top
 - Residential walk-in shower with shampoo/soap holder and teak seat
 - Washer/dryer prep

Base price	121,793.00
GRAPHICS	n/c
USA STANDARDS	n/c
CUSTOMER VALUE PACKAGE	
W/15,000 BTU AC & HEAT PUMP	4,875.00
NORTH POINT LUXURY PACKAGE	10,200.00
FIVE STAR HANDLING PACKAGE	5,993.00
OVERLANDER II SOLAR PACKAGE	1,943.00
EXTREME WEATHER PACKAGE	743.00
3RD AC 15,000 BTU IN LIVING ROOM	1,193.00
21 CU. FT. RESIDENTIAL REFRIGERATOR WITH INVERTER	n/c
GENERATOR LP PREP	743.00
GASELECTRIC DSI WATER HEATER	n/c
BACKUP SIDE AND ENTRY DOOR OBSERVATION CAMERA	n/c
PREP	n/c
TINTED SAFETY GLASS WINDOWS	n/c
NO AWNING	n/c
ROOF LADDER (STD)	n/c
ELECTRONIC DRUM BRAKES	n/c
KING BED	n/c

UNIT TOTAL 147,483.00

DEALER INSTALLED OPTIONS

Manufacturer's Suggested Retail Price \$147,483.00

TOTAL AMOUNT DOES NOT INCLUDE STATE AND LOCAL TAXES OR LICENSE FEES. THE PRICE SHOWN ABOVE MAY OR MAY NOT BE REPRESENTATIVE OF THE ACTUAL SELLING PRICE OF SIMILAR RECREATIONAL VEHICLES IN YOUR AREA.

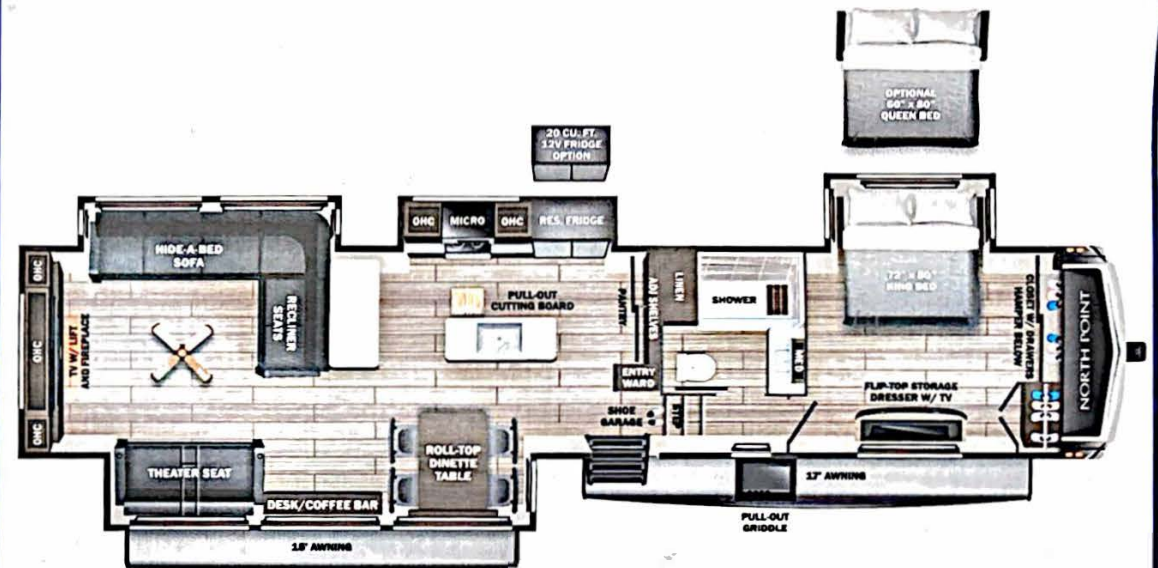

UVW 15362 lbs **Sleeps** **Length** 42' 6"

DIMENSIONS

Exterior height:	159.75"
Exterior width:	102.00"
WEIGHTS	
GVWR:	17995
GAWR (front):	8000
GAWR (rear):	8000
Approx. Gross Cargo Carrying Capacity (GCC):	2633

CAPACITIES

Fresh water tank (gals.):	75.00
Gray water tank (gals.):	87.00
Black water/toilet tank (gals.):	50.00
Propane (lbs.):	120
Propane (gals.):	28
Water heater (gals.):	16.00

TIRES

Tire size (front):	215/75R17.5H
Tire size (mid):	
Tire size (rear):	215/75R17.5H
Tire size (spare):	215/75R17.5J

SEATING & SLEEPING

Some dimensions may be rounded and may vary from the actual dimensions
 Weights may be estimated calculations and may vary from the actual weight - refer to the vehicle weight labels for actual weights
 Floorplans, features and specifications are subject to change without notice.



85-22565N